

# Amelia: Lot 30



the "AMELIA"



BONUS ROOM  
11'8"x18'10"

2nd FLOOR PLAN 240 SQ.FT.  
1114 TOTAL SQ.FT.

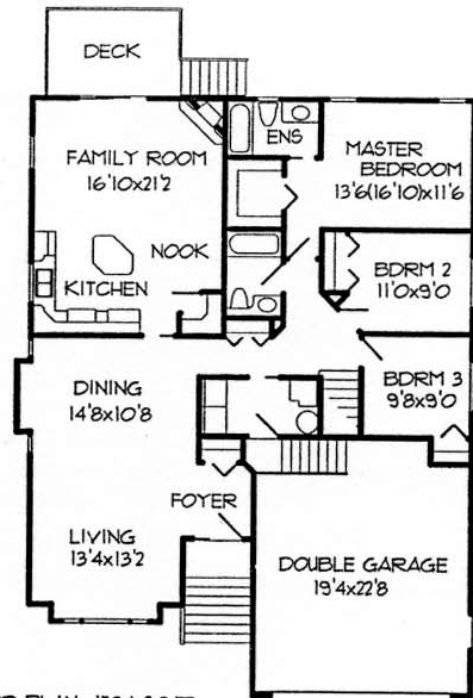

MAIN FLOOR PLAN 1534 SQ.FT.



Marketed Exclusively by

**MIKE JEEVES**

Office: (604) 796-3000 Cell: (604) 316-4914

[www.mikejeeves.com](http://www.mikejeeves.com) | [mikejeeves@shaw.ca](mailto:mikejeeves@shaw.ca)

**RE/MAX**  
Nyda Realty

